

# INSTALLATION INSTRUCTIONS

## Ceiling Roses

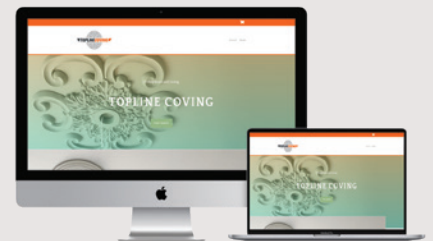

V1225



WWW.TOPLINECOVING.CO.UK  
>> INSTALLATION

### 1 Preparation & cleaning

Store ceiling roses and adhesives at room temperature for at least 24 hours before installation.

Ensure the installation area is clean, dry, and structurally sound. Lightly sand the ceiling if required to create a smooth, flat surface. Vacuum the area thoroughly and wipe down with a damp cloth to remove all dust, grease, or residue. Allow the surface to dry completely before proceeding.

Ready? Set? Go!



INSTALLATION  
GUARANTEE



### 2 Adhesives & Fixing

Polyurethane ceiling roses are suitable for interior and exterior installation when installed and finished correctly.

#### Interior Surface

Ensure all surfaces are sound and in good condition. Use a high-strength, quick-grab coving adhesive suitable for polyurethane mouldings. Depending on the size and weight of the ceiling rose, panel pins (thin nails) may be required.

The adhesive should be solvent-free, overpaintable, and preferably combine adhesive and filler properties.

#### Exterior Surface

Ensure surfaces are sound, clean, and dry before installation. Use a waterproof, frost-resistant exterior coving adhesive suitable for polyurethane. Galvanised or stainless steel panel pins may be required depending on size of the rose.

**Important:** External ceiling roses must be painted with two coats of exterior paint promptly after installation. Do not leave unpainted roses in direct sunlight.



#### Coving Adhesive & Joint Filler

Must be: High strength, quick grab, dries white, overpaintable

Use a high-strength, quick-grab coving adhesive, preferably solvent-free and combining adhesive and filler properties in one product. The adhesive should be suitable for polyurethane mouldings, provide a strong initial grab, dry white, and be overpaintable once fully cured.



3



## INSTALLATION INSTRUCTIONS CONTINUED

## Ceiling Roses



Skip this step if the ceiling rose is purely decorative, will not be used with lighting, or already has a central hole.

1. Identify the centre point of the ceiling rose.
2. Drill a straight hole through the centre, ensuring it is wide enough for electrical cables or light fixings.
3. Allow sufficient cable length to accommodate the depth of the ceiling rose before cutting or terminating cables.

3A

Ø &lt; 65cm

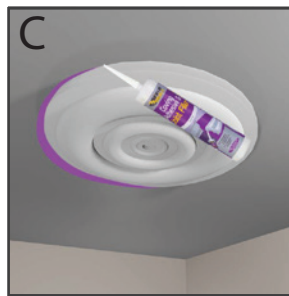
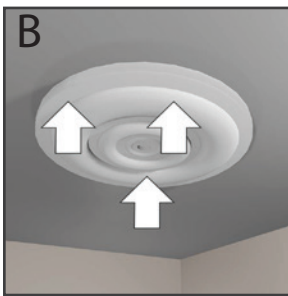
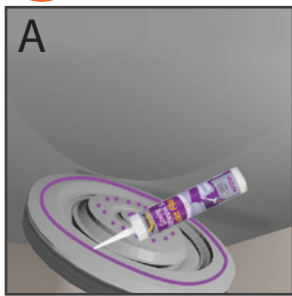

Ceiling roses under 65cm in diameter can normally be installed using adhesive alone. Optional nailing is possible if required (see 3B).

- A. Apply a continuous, unbroken bead of coving adhesive around the entire perimeter of the ceiling rose, with additional dabs across the centre.
- B. Press the ceiling rose firmly into position using a slight twisting motion to ensure full adhesive contact. Hold in place until an initial grab is achieved. If necessary, temporarily support the rose until the adhesive has fully cured (typically up to 24 hours, depending on adhesive used).
- C. Once set, fill any gaps around the edge and repair any fixing marks using additional coving adhesive, decorators' caulk, or a suitable decorators' filler.

3B

Ø &gt; 65cm

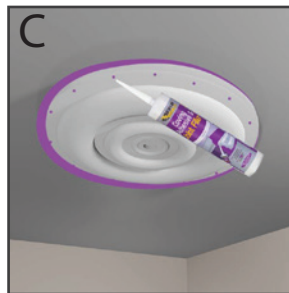
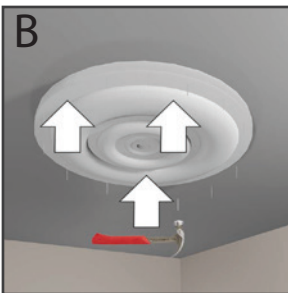
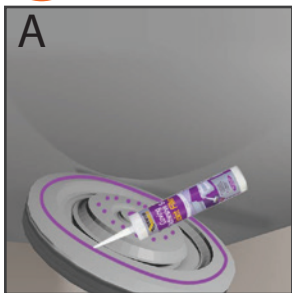

Ceiling roses over 65cm in diameter should be installed using both adhesive and mechanical fixings.

- A. Apply a continuous, unbroken bead of coving adhesive around the entire perimeter of the ceiling rose, with additional dabs across the centre.
- B. Press the ceiling rose firmly into position using a slight twisting motion to achieve full adhesive contact. Once positioned, secure the rose using panel pins or thin nails at approximately 25cm intervals around the perimeter. Fix nails through flat sections of the rose at least 25mm in from the outer edge. Where possible, drive nails at a slight angle (approx. 80°) for improved grip. Ensure nail heads are punched at least 2mm below the surface to allow for easy filling.
- C. Allow the adhesive to fully cure. Once set, fill all perimeter gaps and nail holes using coving adhesive, decorators' caulk, or a suitable filler, and smooth ready for painting.

The ceiling rose is now ready to be painted.

Most water-based and oil-based paints are suitable for use with Topline Coving polyurethane products. We recommend testing a small, inconspicuous area before full overpainting.

For further instructions or information on any topline coving products please visit:

